

Object name

**Multifamily house Lerchenpark Lauterach****Austria**

Object photo



Object description

Wohnbauselbsthilfe has built a residential complex consisting of 4 3-storey buildings with 20 dwelling units and an underground garage each in Lauterach. As the name „Lerchenpark“ („lark park“) says, the residential complex is designed like a park and has spacious playground and leisure areas for young and old.

The building project is erected according to the ecological measures catalogue of the province of Vorarlberg, it is handicapped-accessible and meets the passive house standard.

In each building there are 2 staircases with elevators to access the apartments. Each unit has a balcony or garden with a terrace on the ground floor.

Basement: Shallow foundation, reinforced-concrete floor slab with mono-finish surface. Access corridors sealed. Reinforced-concrete walls and ceiling made of fair-faced concrete. Access corridors painted.

Upper floors: The buildings are built in skeleton construction using reinforced-concrete ceilings and load-bearing steel supports. The exterior walls are built in multi-box timber construction clad with vertical unplanned larch formwork. On the inside, a single facing shell in which the steel supports are packed is mounted.

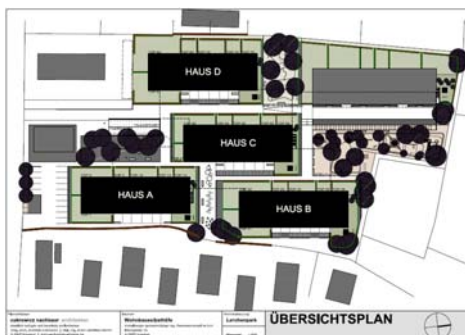

Fact sheet

**Multifamily house in 6923 / Lauterach**

Treated Floor Area	6.596 m <sup>2</sup>
Number of apartments	80
Completion date	2009

**Energy standard [PHPP]**

Heat requirement / year	15 kWh/m <sup>2</sup> a
Heat load	10 W/m <sup>2</sup>
Primary energy requ.	XXX kWh/m <sup>2</sup> a
Air-tightness (n <sub>50</sub> -value)	0,30 1/h
Building type	Mix construction

**U-value**

Exterior wall	0,12 W/m <sup>2</sup> K
Roof	0,10 W/m <sup>2</sup> K
Basement floor / Floor slab	0,16 W/m <sup>2</sup> K
Windows / average	0,XX W/m <sup>2</sup> K

**Specification ventilation system**

Semi central system

**Heating installation**

Heat pump

Construction costs X.XXX Euro/m<sup>2</sup>**Building owner**

Wohnbauselbsthilfe Vorarlberger gem. reg. GenmbH  
[www.wohnbauselbsthilfe.at](http://www.wohnbauselbsthilfe.at)

**Architect/Planner**

Architekturbüro Cukrowicz.Nachbaur

**Photo credits**

Wohnbauselbsthilfe